



ALPHA SERIES

MUNCIE'S PTO FOR DODGE CHASSIS CABS

**ALPHA MAKES INSTALLATION EASY- PROVIDING
MAXIMUM CLEARANCE USING DURABLE
PROVEN COMPONENTS.**

- **COMPACT SIZE**
- **INTEGRAL SHIFTER**
- **ELECTRIC/HYDRAULIC OR
CABLE OPTIONS**
- **MULTIPLE RATIOS AND
OUTPUT OPTIONS**
- **PUMP MOUNTS TO FRONT
OR REAR**
- **INTERNAL COMPONENTS
COMMON TO TG SERIES**



CONTACT MUNCIE FOR ADDITIONAL INFORMATION OR TO PLACE YOUR ORDER.

ALPHA SERIES

MODEL NUMBER CONSTRUCTION

A 1 6M - D94 13 - C 2 T X

MODEL
ALPHA - A

DESIGN NUMBER
1

MOUNTING
6-BOLT EXTRA DEEP MOUNT - 6M

INPUT GEAR
MERCEDES/DODGE G56-6 - D94

RATIO

| | |
|------------|-------------|
| 07 - .72:1 | 12 - 1.17:1 |
| 08 - .89:1 | 13 - 1.28:1 |
| 09 - .92:1 | 15 - 1.50:1 |
| | 18 - 1.72:1 |

SPECIAL FEATURES
X - NONE

OUTPUT TYPE

- B - 1 1/4 RD (4X2 Only)
- K - SAE B 2&4 BOLT (4X2 Only)
- Q - SAE A 7/8 13T **
- R - SAE A 5/8 9T **
- S - SAE B 2 Bolt (4X4 "1" Arrng Only)
- T - SAE A 3/4 11T **

** (4X4 "2" Arrng w/ Pump to Rear
OR "1" Arrng w/ Pump to Front)

ASSEMBLY ARRANGEMENT

- 1 - 4X4 PUMP TO FRONT
- 2 - 4X4 PUMP TO REAR
- 4 - PUMP TO REAR 4X2 ONLY

SHIFT TYPE

- C - CABLE
- T - E-HYDRA (call for availability)

DIMENSIONS

2-Assembly Arrangement with Muncie PF Series pump mounted to rear of PTO.
Pump rotation - CCW

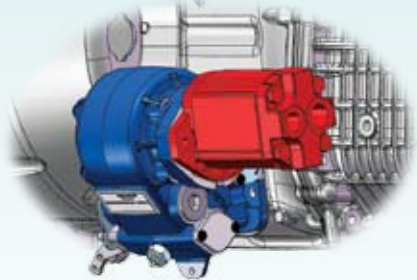

"T" Option - SAE A 2-Bolt
3.25" Pilot - 3/4" 11T Spline
3/8-16UNC-2B on 4.18" B.C.

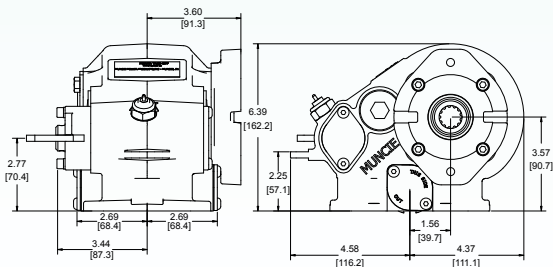

1-Assembly Arrangement with Muncie PKS Series pump mounted to front of PTO.
Pump rotation - CW

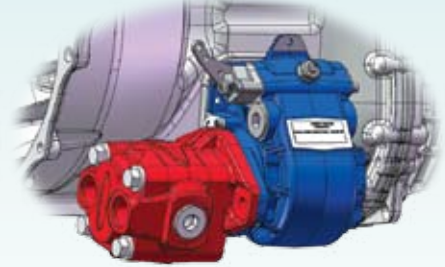

"S" Option - SAE B 2-Bolt
4" Pilot - 7/8" 13T Spline
1/2-13UNC-2B on 5.75" B.C.

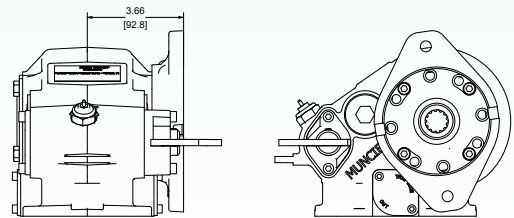

MP09-06 Printed in the U.S.A.
© Muncie Power Products, Inc. 2009

Muncie Power Products, Inc. Member of the Interpump Hydraulics Group
General Offices and Distribution Center • P.O. Box 548 • Muncie, IN 47308-0548
(765) 284-7721 • FAX (765) 284-6991 • E-mail info@munciepower.com
Web site <http://www.munciepower.com>

Drive Products, Exclusive Agents for Canada, ISO Certified by an Accredited Registrar

